



User Manual

Mandala Breeze



Please read the manual before using the tools.

Version 7.4

Updated December 5th, 2025

1. General Notes

1.1 Product Feature and Intend Use

Mandala Breeze is a sleek, portable wellness device that helps restore balance and reduce stress using magnetic fields, light therapy, and gentle vibrations. Its quantum and bifilar coils fine-tune your body's energy flow, promoting relaxation and well-being.

Pair it with the Mandala Breeze app, which allows you to upload and create custom playlist for personalized energy balancing. The app also includes basic pre-set programs for immediate use. Additionally, by integrating Mandala Scan, you can analyze your body's energy state and identify the best coherence preset to upload for optimal results.

Your Mandala Breeze has been quality-tested and is ready to support your wellness journey anytime, anywhere.

1.2 Product Details

- Light and sound frequency adjustment equipment for therapy and healing
- Use electronic control circuits
- Output uses LED RGB, LED UV-C, IR-LED, and PCB Coil
- Supports Bluetooth for mobile control

1.3 Safety Warnings

- Check all accessories upon unboxing.
- Read and follow all safety instructions in the manual.
- Do not use near water or in wet areas.
- Do not open the cover unless you are a professional technician.
- Avoid placing the device near heat sources (e.g. stoves).
- Only use the power voltage specified in the manual.

1.4 Warranty

- Your Mandala Breeze includes a one-year warranty from the date of purchase.
- If you experience any issues, contact customer support immediately.
- The warranty does not cover damage due to:
 - Misuse or neglect
 - Unauthorized modifications or disassembly
 - Customs/import fees or indirect damage
 - If repairs are needed due to misuse, all costs (including shipping) will be the user's responsibility.

1.5 Important Precautions

- Do not use the device if it appears damaged. Contact customer support team.
- Ensure the correct voltage for your country before use.
- Charge for at least 1 and half hours before the first use.
- If unused for a long time, charge for at least 2 hours before using again.
- Do not disassemble or modify the device.
- Keep the device in a dry, cool place, away from moisture, heat, dust, and direct sunlight.

1.6 Maintenance

1. Keep the device clean to ensure optimal performance.
2. Use soft, dry cloth or a water-based glass cleaner for cleaning. Avoid harsh chemicals or abrasive materials.
3. If you experience any issues, please contact our customer service team.

1.7 Product Includes

1. Mandala Breeze
2. USB Type-C cable
3. Neck strap
4. Package box



2. Technical Data

2.1 Specifications

Product name:	Mandala Breeze
Color:	White
Material:	ABS + Acrylic
Working Voltage:	5V DC
Charging Interface:	USB Type-C
Battery:	Lithium polymer 3.7 V/500mA
LED Output:	LED RGB, LED UV-C, IR-LED และ PCB
Coil Output:	Bifilar Coil / Quantum Coil

Signal frequency:	1Hz – 35 kHz
Bluetooth:	Bluetooth 5.0
Length:	45 mm.
Width:	45 mm.
Height:	18 mm.
Weight:	320 grams

2.2 Overview and Function

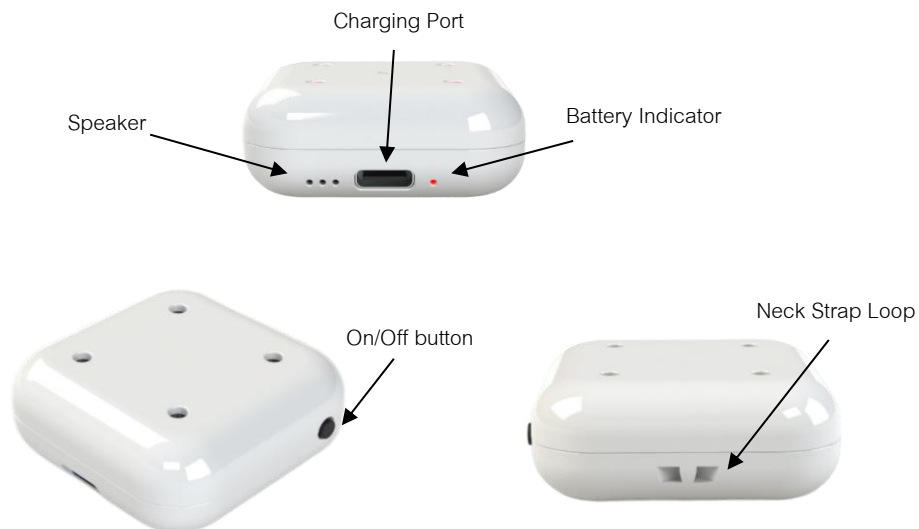

2.3 Basic Operation

- To turn on the device, press the button once. The device will start working according to its basic functions.
- Connect to your mobile phone via Bluetooth: BZ2-XXXX
- Select the desired treatment program via the application.
- To turn off the device, press the button twice in a quick double-press. The device will stop working immediately.
- After turning on the device, the machine will automatically turn itself off after 60 minutes per usage.

2.4 Charging Setup

1. To charge the Mandala Breeze, connect the USB-C cable to the device and a power adapter, then plug it into a power source.
2. Charging takes about 1 and half hours from an empty battery and lasts over 4 hours. *(Battery capacity can be reduced)*
3. When the battery is dying, the red LED will flash to indicate low battery.
4. When the battery is charging, the device will not work, the red LED will flash to indicate that it is charging.
5. When the battery is full, the red LED will remain on, indicating ready to use.



To protect the battery life span, please don't overcharge the battery.

3. Mandala Breeze Application (11 Languages Available)

3.1 Application Setup

The Mandala Breeze app is available on iOS and Android. Download it from the App Store for iOS or Google Play Store for Android. For users in China, please download it from <https://light-mandalas.com/downloads>

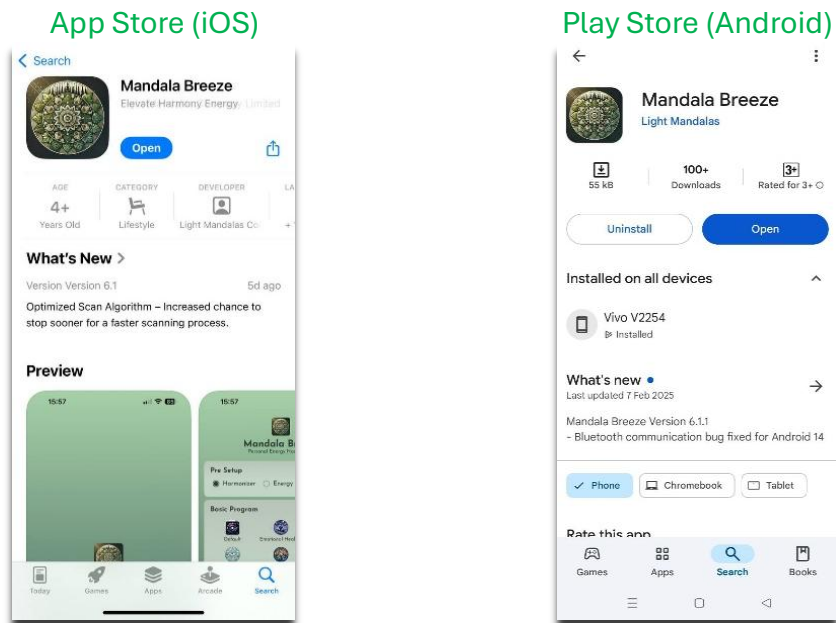

3.2 Pairing Bluetooth with Application

Tap the "Settings" icon at the bottom right, then select "Set Up Mandala Breeze." The app will search for nearby devices. Choose the displayed serial number to connect via Bluetooth.

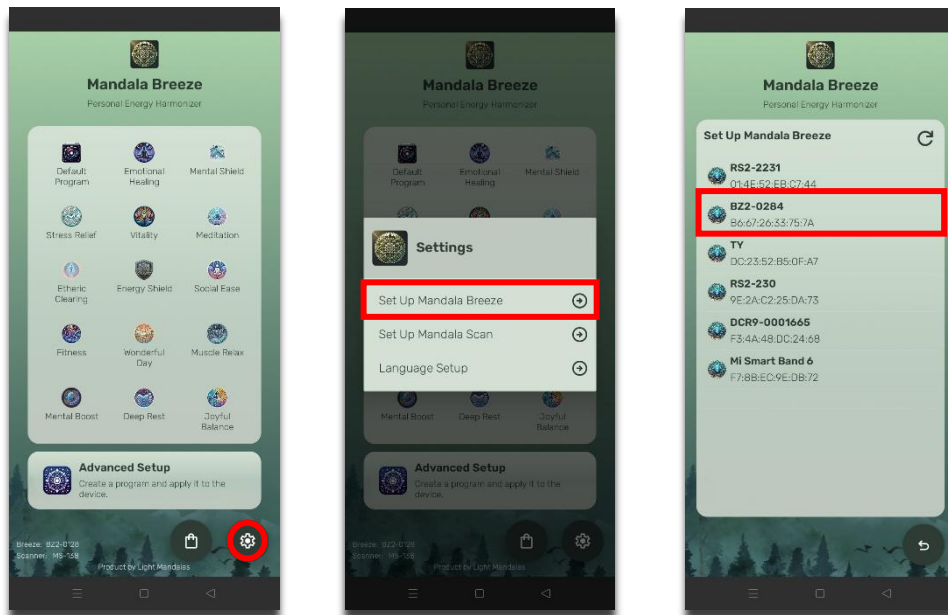

3.3 Initial Setup

Default Program:

Balances energy to create a calm and stable atmosphere.

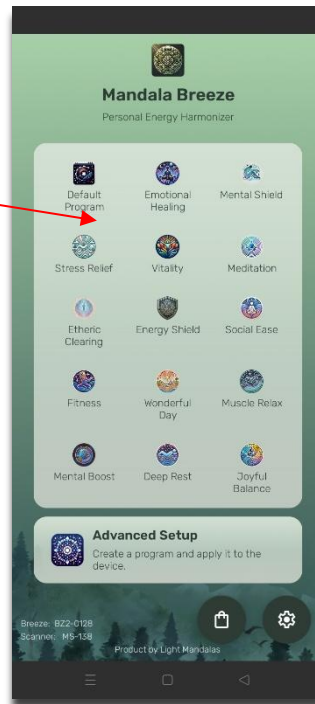

3.4 Basic Program

After setting up the app, select your preferred program and tap "Apply" to upload it to the device.

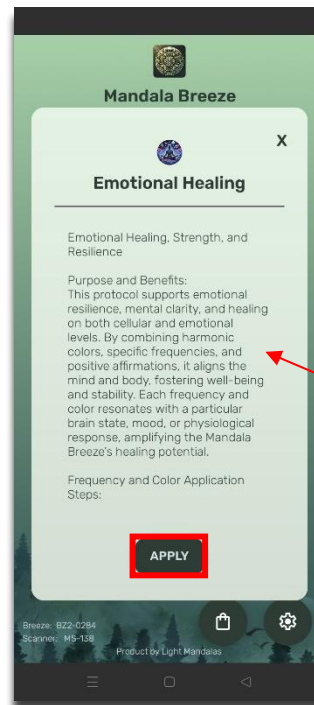
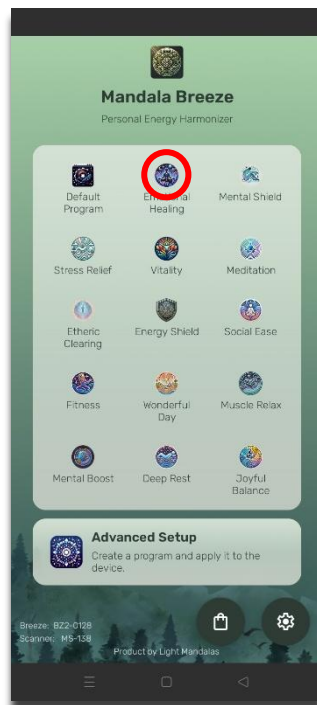

Basic description and instructions

3.5 Advanced Setup

“Advanced Setup” allows users to customize frequency settings using the library or their own frequencies. Users can combine frequencies to create a preset or their own programs.

3.5.1 Library

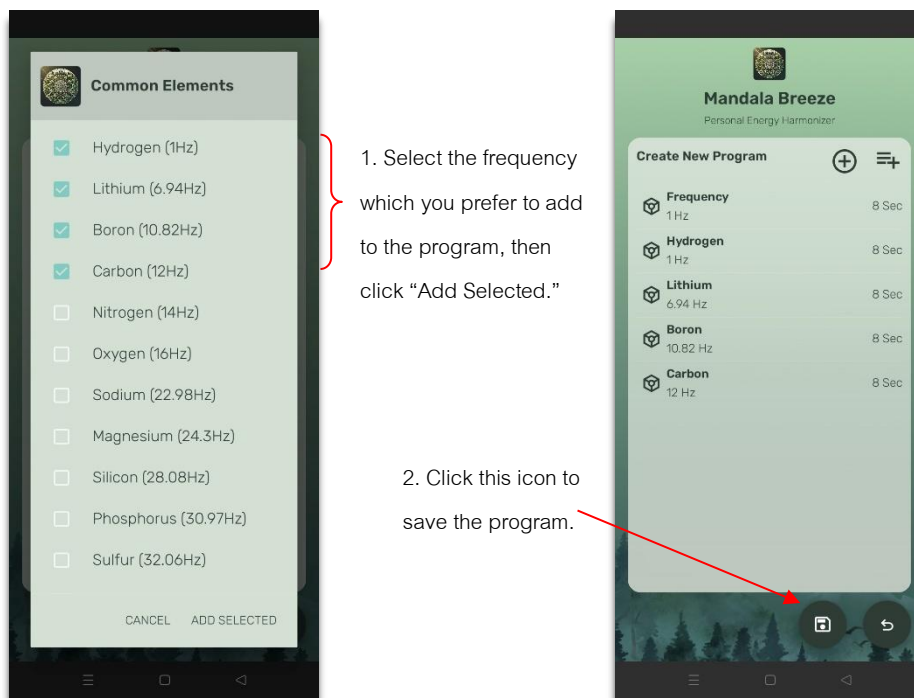
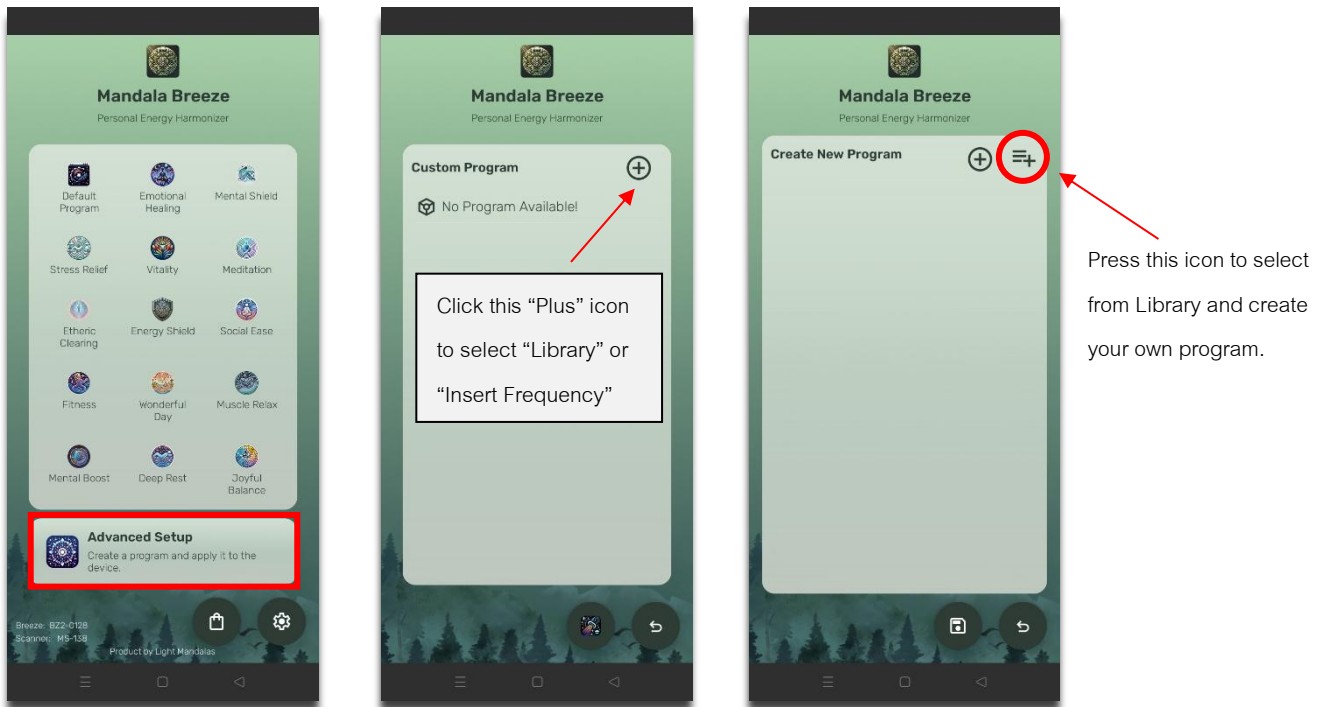

3.5.2 Insert Frequency

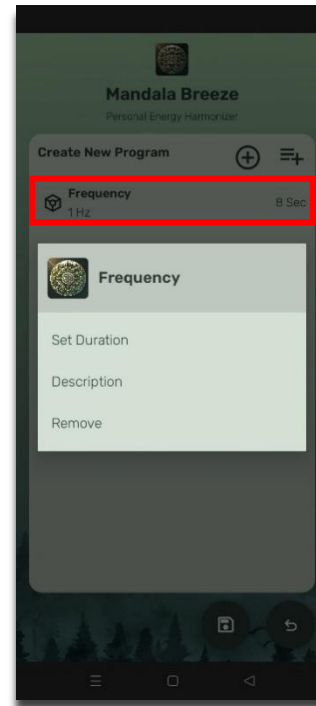
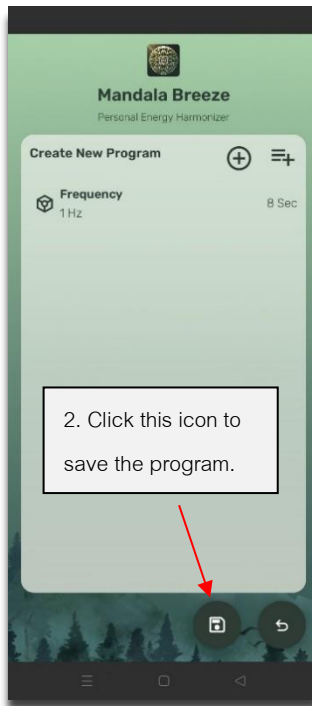
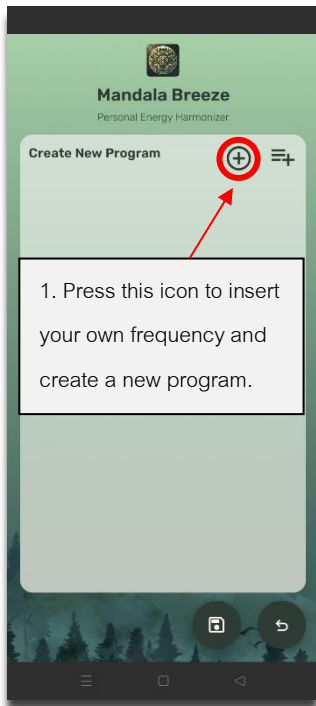

3.6 Mandala Scan

To use Mandala Scan, first pair it via Bluetooth. Tap the "Settings" icon, select "Mandala Scan Setup," and choose the displayed serial number to connect.

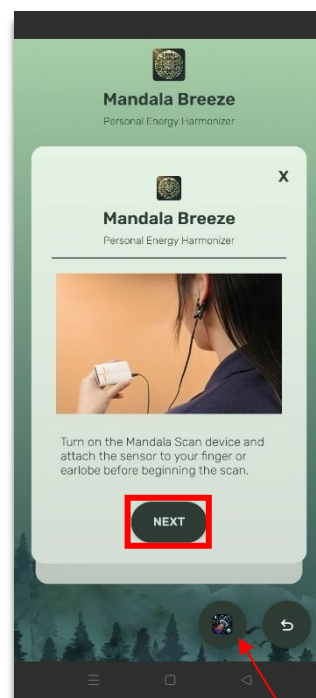
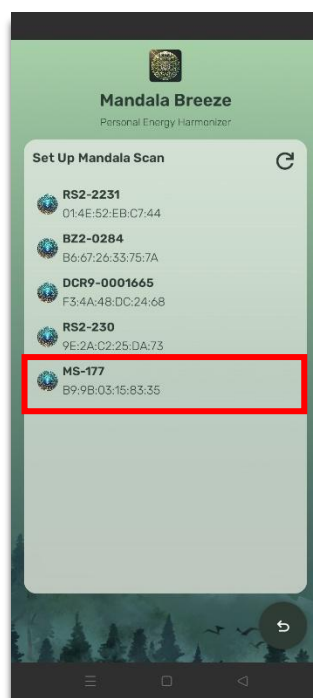
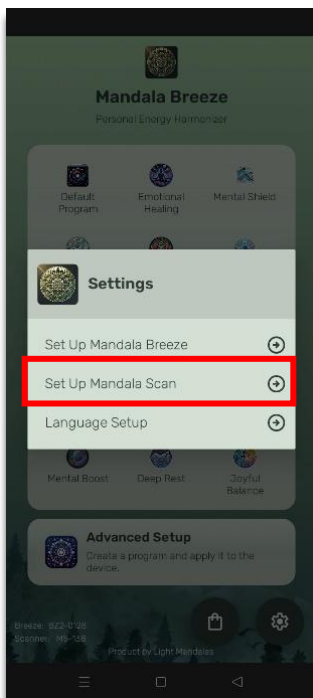

3.6.1 Smart Scan

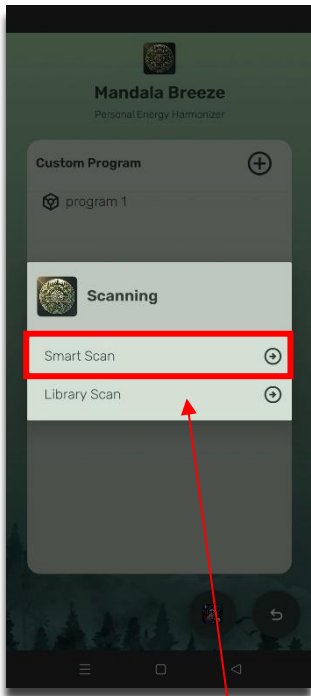

Smart Scan analyzes your body and identifies the frequencies that best support your needs at this moment.

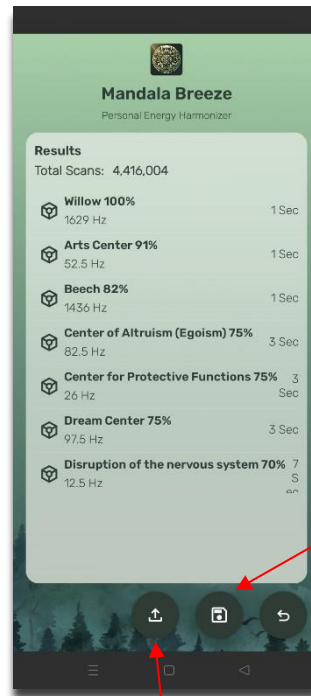
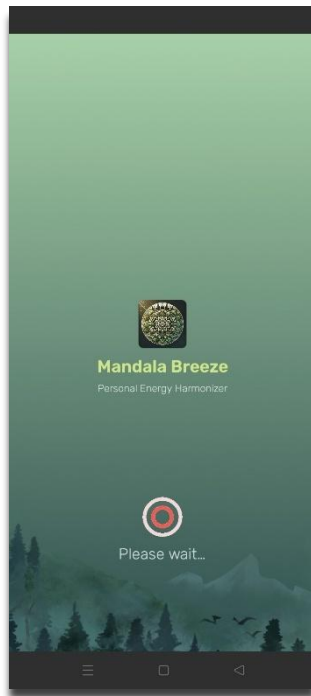

Save the program.

Click this icon to upload the scan results or the frequencies to Mandala Breeze.

3.6.2 Library Scan

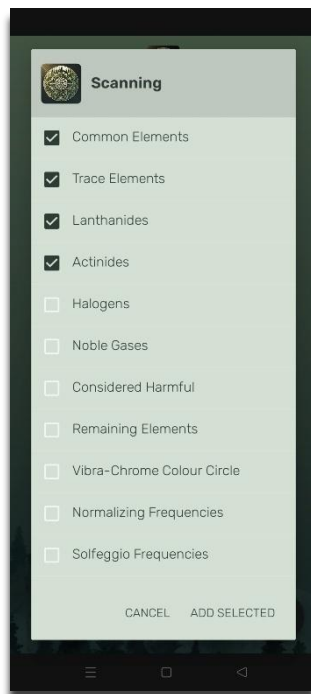
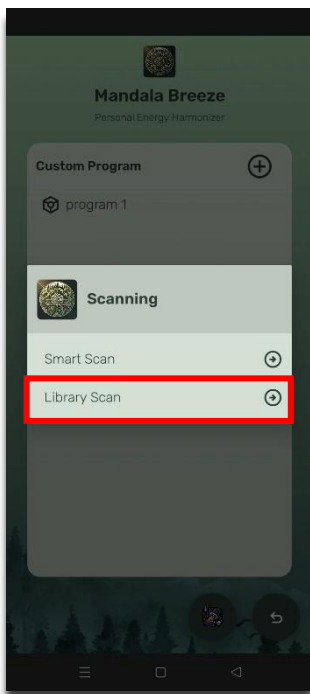

Select the library you want to scan, then click "Add Selected" to begin scanning.



Failures Remedies

Device cannot turn on

- The battery is low. Please charge the device.

Disclaimer

Light Mandalas products are designed as energy support tools for relaxation, stress management, and well-being. They are not medical devices and do not replace professional medical treatment or advice.

Any experiences or testimonials shared regarding the use of our products reflect individual responses and are not guaranteed outcomes. Since personal energy and emotional states vary, users may experience different effects, including heightened sensitivity or discomfort. By using our products, you acknowledge that all outcomes are your sole responsibility.

Light Mandalas Co., Ltd. (Thailand) is not liable for any unintended effects, discomfort, or injuries that may arise from product use. If you have any medical concerns, please consult a healthcare professional before using our products.

For any questions, please reach out to us for further support.

Light Mandalas Co., Ltd. (Thailand Headquarters):

- Light Mandalas Website: www.light-mandalas.com
- Email: info@light-mandalas.com
- Tel: 093-132-9333, 091-628-9936
- Instagram: [@mandalawave9](https://www.instagram.com/mandalawave9)
- YouTube Channel: Light Mandalas Official
- TikTok: Light Mandalas
- WeChat: Light Mandalas 光之曼陀罗
- Technical Support Email: cservice@light-mandalas.com