



# User Manual

## Mandala Violet Shield



Please read the manual before using the tools.

Version 4.5

Updated 5<sup>th</sup> December 2025

## **1. General Notes**

### **1.1 Product Feature and Intend Use**

Mandala Violet Shield is a sleek, portable wellness device designed for energetic protection and purification. Using UV-C light, plasma technology, and harmonic frequencies, it neutralizes negative energy, clears blockages, and stabilizes your auric field. The Violet Shield helps create a high-vibration environment, supporting physical, emotional, and energetic well-being.

Pair it with the Violet Shield app, which allows you to customize over 1,800 pre-programmed frequency settings for personalized energy balancing. The app also includes preset programs for immediate use. Additionally, by integrating Mandala Scan, you can analyze your body's energetic state and select the most coherent frequency for optimal protection.

Your Mandala Violet Shield has been quality-tested and is ready to support your wellness journey—anytime, anywhere.

### **1.2 Product Details**

- Light Frequency Modulator for well-being.
- Uses Electronic Circuit Control.
- Uses UV-C Lamp as output.
- Support Bluetooth for Mobile Control.
- Use the Jack Output 3.5 mm to listen to music through the device.

### **1.3 Safety Warnings**

- Check all accessories upon unboxing.
- Read and follow all safety instructions in the manual.
- Do not turn on and inhale the gas for a long time.
- Do not turn on the water or in the wet area.
- Do not disassemble unless you are a qualified technician.
- Avoid placing the device near heat sources such as stoves.
- Use only the power voltage specified in the manual.

## **1.4 Warranty**

- Your Mandala Violet Shield includes a one-year warranty from the date of purchase.
- If you experience any issues, contact customer support immediately.
- The warranty does not cover damage due to:
  - Misuse or neglect
  - Unauthorized modifications or disassembly
  - Customs/import fees or indirect damage
  - If repairs are needed due to misuse, all costs (including shipping) will be the user's responsibility

## **1.5 Important Precautions**

- Do not use the device if it appears damaged. Contact support.
- Ensure the correct voltage for your country before use.
- Charge for at least 1 and a half hours before the first use.
- Keep dry – avoid rain, high humidity, heat, and dust.

## **1.6 Maintenance**

1. If unused for a while, charge the device for 2 hours before use.
2. Use a soft cloth or water-based glass cleaner for maintenance.
3. Keep the device clean to ensure proper performance.

## **1.7 Product Includes**

1. Mandala Violet Shield
2. USB Type-C cable



## 2. Technical Data

### 2.1 Specifications

Product name:	Mandala Violet Shield
Color:	White
Material:	ABS, acrylic, stainless steel
Pressure:	5V DC
Charging Interface:	USB Type-C
Battery:	Lithium polymer 3.7 V/3300mA
UV Wavelength:	185-254nm
Signal Frequency:	1Hz – 25 MHz
Bluetooth:	Bluetooth 5.0
Length:	47 mm.
Width:	36.20 mm.
Height:	219 mm.
Weight:	165 g.

## 2.2 Overview and Function



1. To turn on the device, press the button once. The device will start to work according to its basic functions.
2. Connect to your mobile phone via Bluetooth: VS-XXXX
3. Select the desired treatment program via the application.
4. To turn off the device, press the button twice in a quick double-press. The device will stop working immediately.
5. After the power goes on, the device will automatically shut down after 45 minutes per usage.

Slightly turn to the right to open Violet Shield.



Take off Violet Shield's cover.



### 2.3 Charging Setup

1. To charge the Mandala Violet Shield, connect the USB-C cable to the device and a power adapter, then plug it into a power source.
2. Charging takes about 1 and half hours from an empty battery and lasts over 4 hours. *(Battery capacity can be reduced.)*
3. When disconnecting the charger - normal use: there will be 4 LED light colors, green, green, orange, red, representing the battery percentage 100% 75% 50% 25%
4. When the battery is almost empty, only the red LED will blink to notify the battery is less than 10%
5. When the battery is charging, the device will not work. The LED will blink according to the battery percentage.
6. When the battery is full, all 4 lights will stay on, meaning it is ready to use.



To protect the battery life span, please don't overcharge the battery.

### 3. Violet Shield Application (11 Languages Available)

#### 3.1 Application Setup

The Violet Shield app is available on iOS and Android. Download it from the App Store for iOS or Google Play Store for Android. For users in China, please download it from <https://light-mandalas.com/downloads>

App Store (iOS)



Play Store (Android)

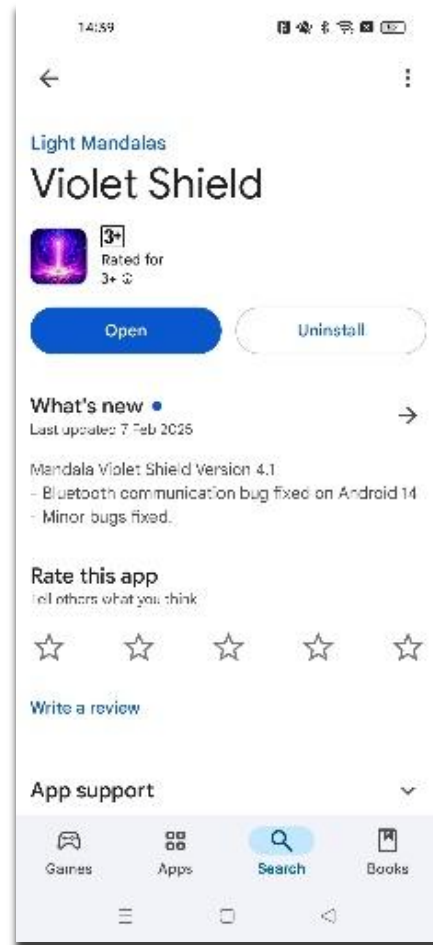

### 3.2 Pairing Bluetooth with Application

Tap the "Settings" icon at the bottom right corner, then select "Setup Mandala Violet Shield."

The app will search for nearby devices. Choose the displayed serial number to connect via Bluetooth.

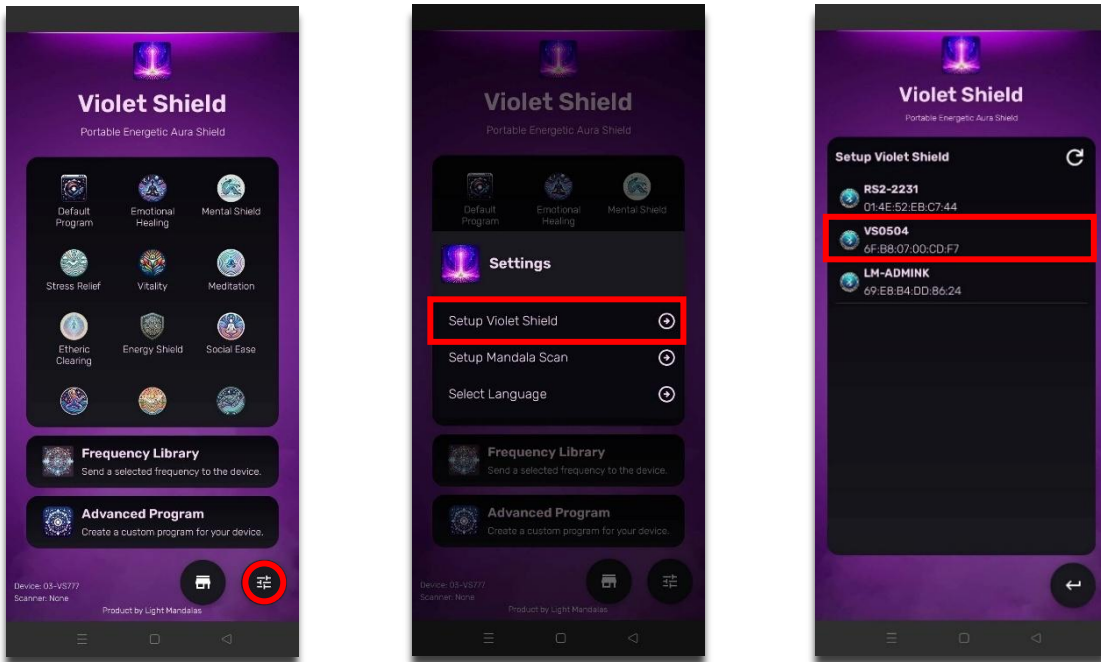

### 3.3 Basic Program

There are 20 programs to choose from. After setting up the app, select your preferred program under "Basic Program" and tap "Apply" to upload it.

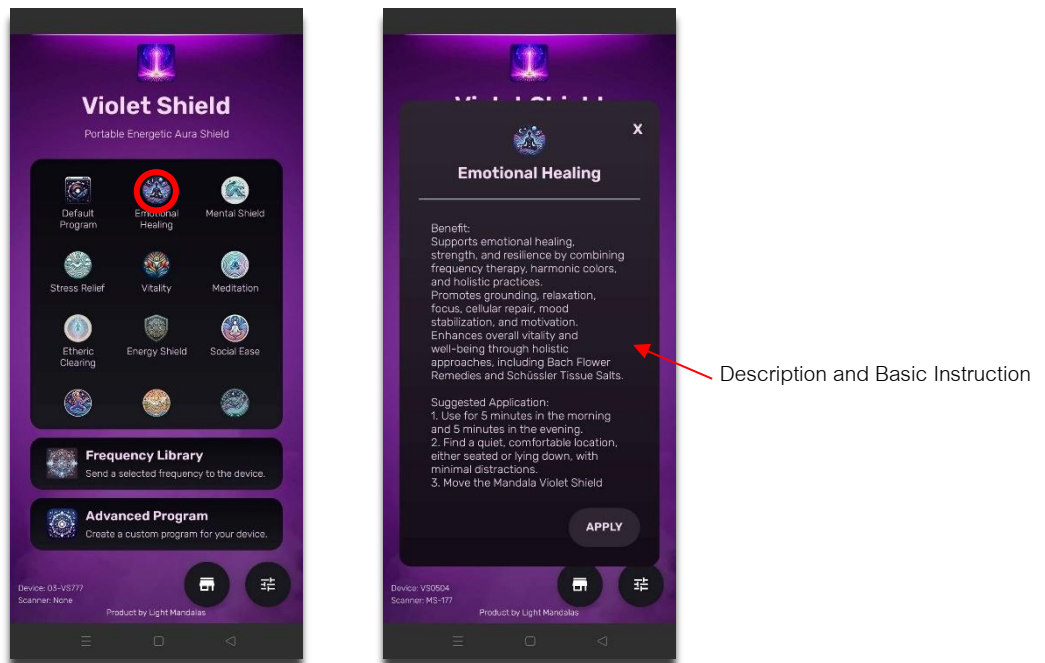

### 3.4 Advance Program

"Advanced Program" allows users to customize frequency settings using the library or their own frequencies. Users can combine frequencies to create a personal program.

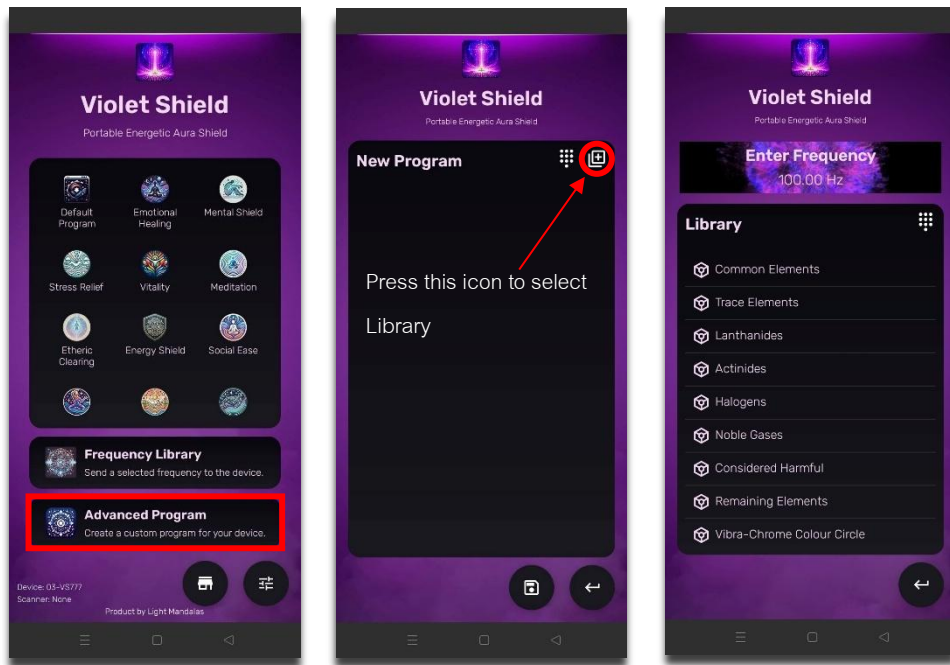

Select your desired frequencies and categories.

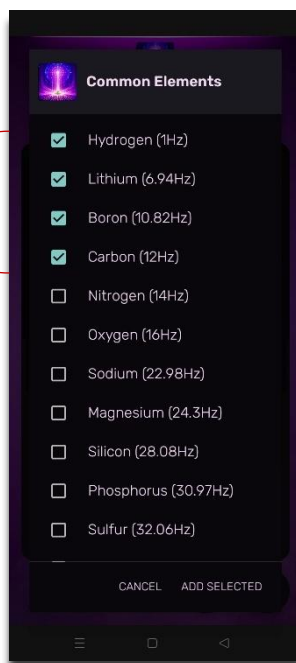

Name your new program and press "Confirm."

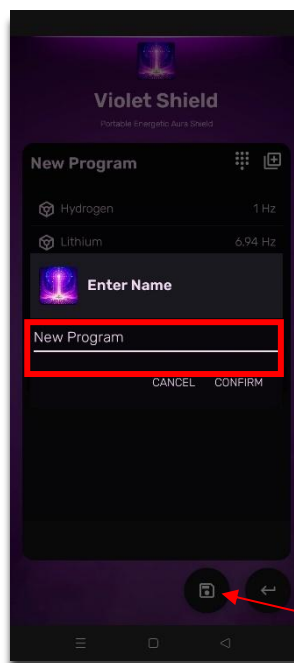

Press this icon to save the new custom program.

### 3.5.1 Frequency Library

Frequency Function has a Library that includes 14 categories to choose from. Frequency mode has a function that allows the user to set their desired frequency from 1-120MHz.

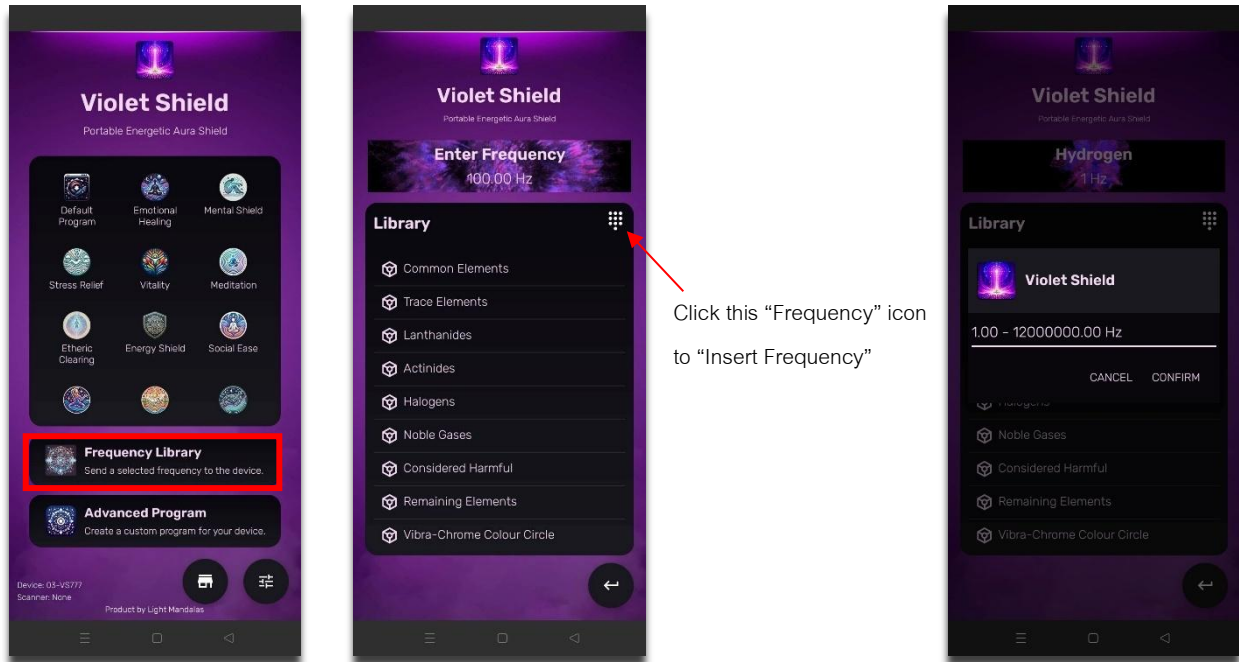

### 3.5.2 Insert Frequency

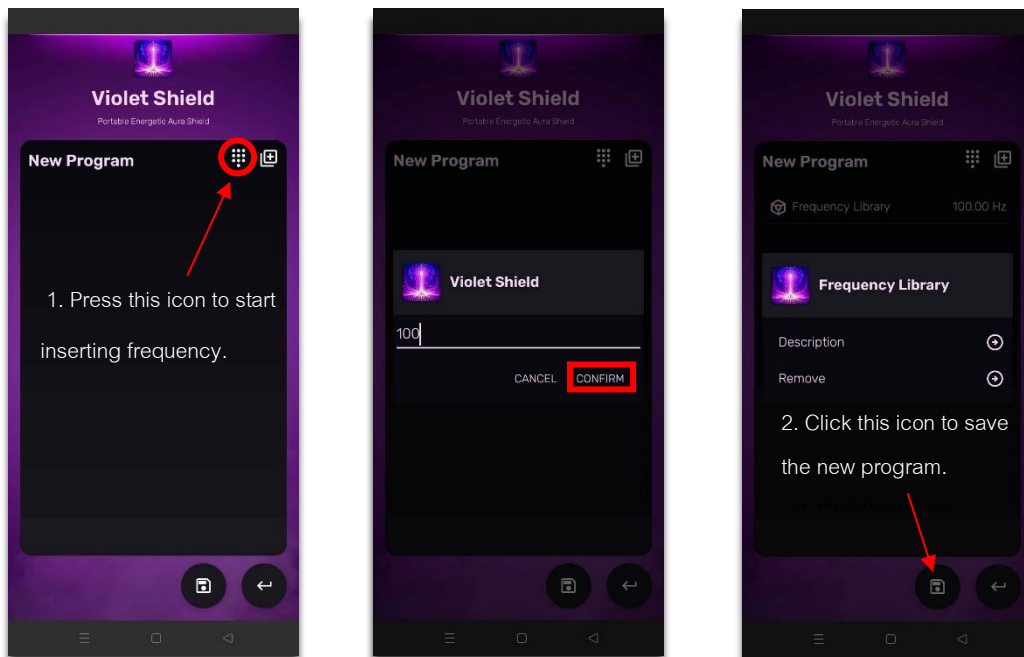

### 3.6 Mandala Scan

To use Mandala Scan, first pair it via Bluetooth. Tap the "Settings" icon, select "Setup Mandala Scan," and choose the displayed serial number to connect.

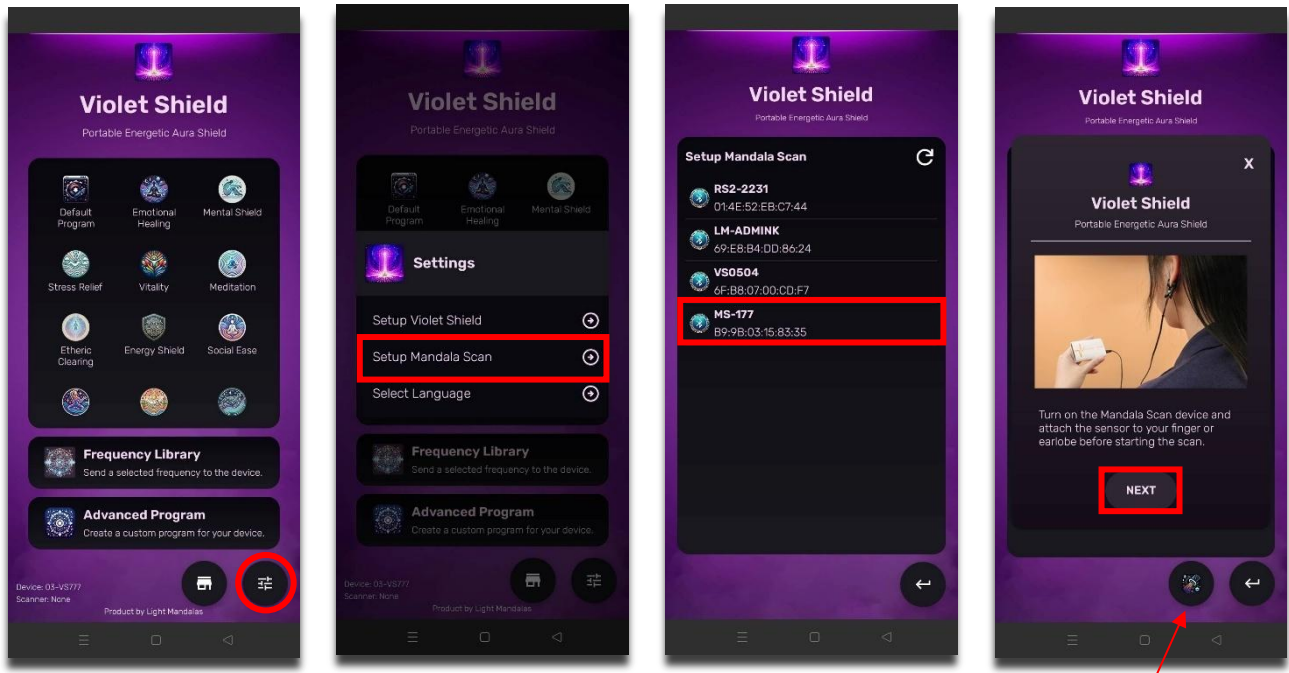

Choose "Advanced Program" then press the "Mandala Scan" icon after pairing Bluetooth. Press "Next" to start.

#### 3.6.1 Smart Scan

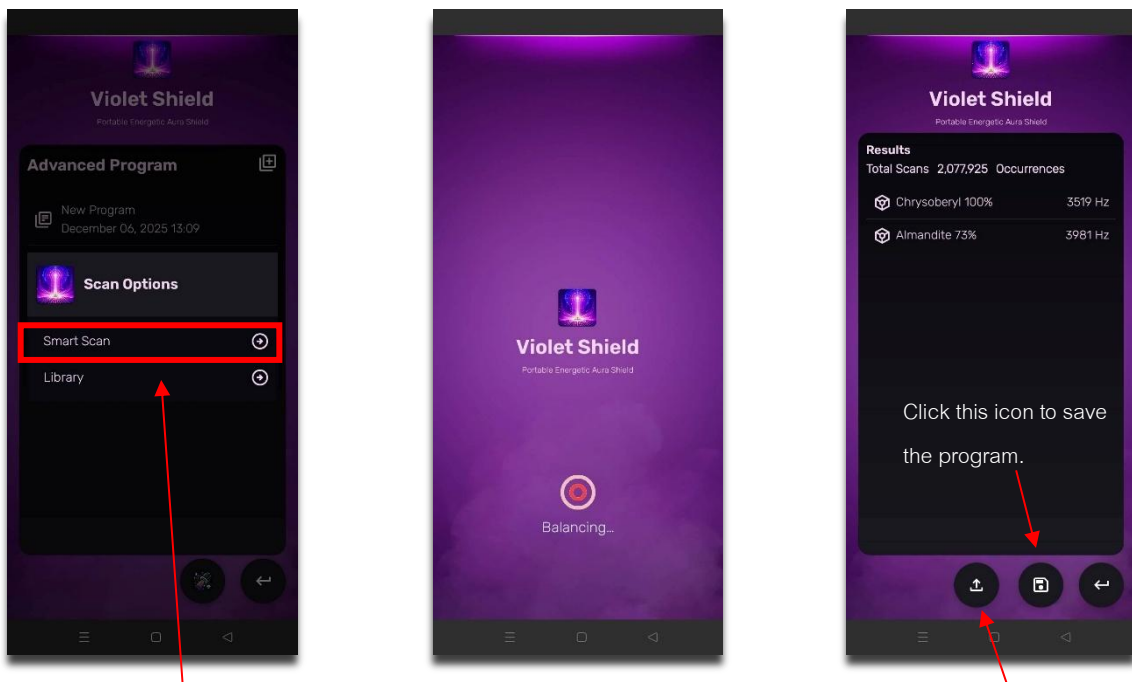

Smart Scan analyzes your body and identifies the frequencies which best support your needs at this moment.

Click this icon to upload the scan results or the frequencies to the Violet Shield.

### 3.6.2 Library (Scan)

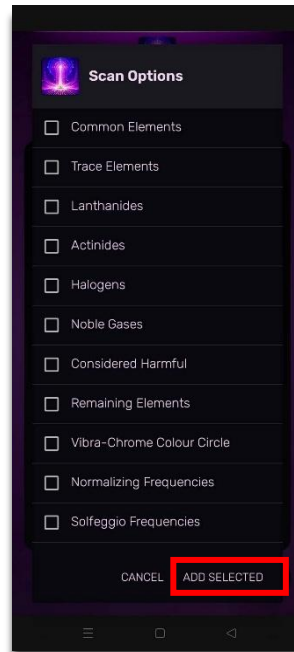
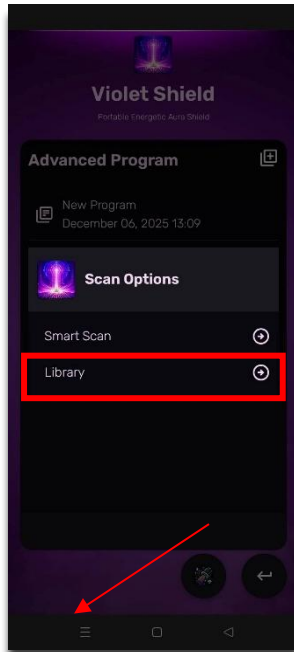

Select the library you want to scan, then click "Add Selected" to begin scanning.

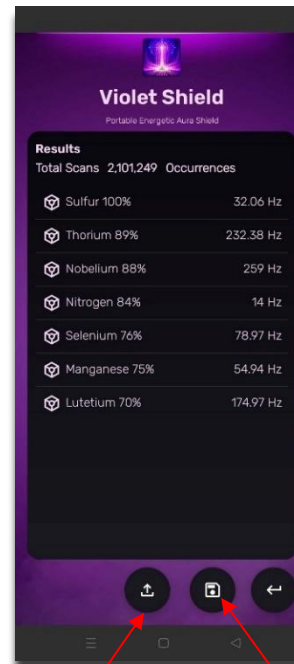

Click this icon to upload the scan results or the frequencies to Violet Shield.

Click this icon to save the results into a new program.

## Failures Remedies

### Device cannot turn on

- The battery is low. Please charge the device.

### Unable to connect with Application

- Turn off the device, unpair Bluetooth, then restart both.

## Disclaimer

Light Mandalas products are designed as energy support tools for relaxation, stress management, and well-being. They are not medical devices and do not replace professional medical treatment or advice.

Any experiences or testimonials shared regarding the use of our products reflect individual responses and are not guaranteed outcomes. Since personal energy and emotional states vary, users may experience different effects, including heightened sensitivity or discomfort. By using our products, you acknowledge that all outcomes are your sole responsibility.

Light Mandalas Co., Ltd. (Thailand) is not liable for any unintended effects, discomfort, or injuries that may arise from product use. If you have any medical concerns, please consult a healthcare professional before using our products.

*For any questions, please reach out to us for further support.*

Light Mandalas Co., Ltd. (Thailand Headquarters):

- Light Mandalas Website: [www.light-mandalas.com](http://www.light-mandalas.com)
- Email: [info@light-mandalas.com](mailto:info@light-mandalas.com)
- Tel: 093-132-9333, 091-628-9936
- Instagram: [@mandalawave9](https://www.instagram.com/mandalawave9)
- YouTube Channel: Light Mandalas Official
- TikTok: Light Mandalas
- WeChat: Light Mandalas 光之曼陀罗
- Technical Support Email: [cservice@light-mandalas.com](mailto:cservice@light-mandalas.com)